

Portable non-contact
thermometer
Wide measurement range type

Measurement range
-40 to 510°C (-40 to 950°F)

THERMO-HUNTER®
PT-2LD

Wide meas- Built-in Simple Large LCD Backlight Automatic
range laser guide operation display power off

Features

-40 to 510°C (-40 to 950°F) wide-range type

This wide-range thermometer can measure from negative temperatures, such as for frozen foods, up to 500°C (932°F). Every PT-2LD thermometer can be used in a wide range of industries and for a wide variety of applications.

Sighting function laser marker included

The laser marker allows users to verify the measurement location even from a distance.

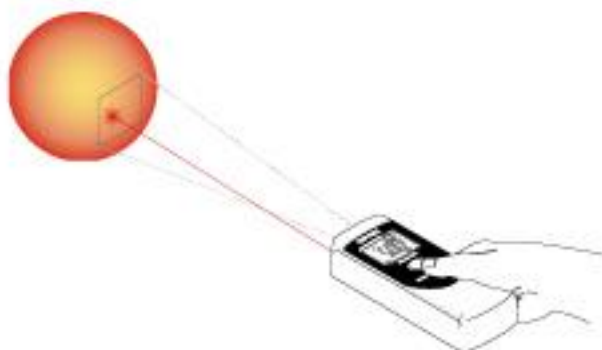

Large LCD and backlight function

This product uses a large LCD screen to display temperatures clearly. The included backlight function allows for reliable use even in dark locations.



Simple, one-button operation

Thanks to a simple design, users can start measurement, turn on the laser, and illuminate the backlight just by pressing one button. This allows for quick measurement immediately after taking the product out of a pocket.



Energy-saving automatic power off function

This function is designed to save power by automatically turning off the power following the 20-second operation of the hold function after a button has been released.

Compact, pocket-sized body

The product is small and lightweight, weighing only 180 g. This compact, pocket-sized design makes it incredibly portable.



Automotive maintenance



Asphalt construction temperature

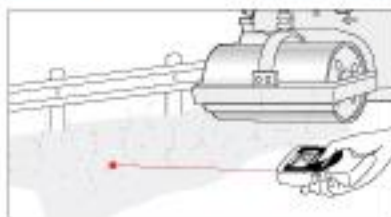

CE



レーザー光
目や皮膚に照らすと有害な場合があります
目や皮膚に照らすときは必ず保護メガネを
着用してください。

レーザー光が照らすと有害な場合があります
目や皮膚に照らすときは必ず保護メガネを
着用してください。



Specifications

Model	PT-2LD
Measurement range	-40 to 510°C (-40 to 950°F) (Display: -51 to 538°C [-59.8 to 1000.4°F])
Field of view	100 × 100 mm / 1000 mm (Refer to field of view)
Optics	Mirror type/Silicon filter
Sensing element/spectral response	Thermopile/8 to 14 μm
Response time	0.8 sec./90% response
Accuracy (α=0.95)	Up to 0°C (32°F): ±3°C (5.4°F), 0 to 200°C (32 to 392°F): ±2°C (3.6°F), 201°C (393.8) and up: ±1% of reading
Repeatability	±1°C (1.8°F) of reading
Display resolution	1°C (33.8°F)
Emissivity (ε) adjustment	0.95/0.70, switchable (switching via DIP switch)
Sighting function	PSC-certified laser marker (Class 2)
Functions	Backlight Automatic power off function
Power supply	AA alkaline battery ×2
Battery life	Approx. 30 hours (when using alkaline batteries)
Ambient temperature	0 to 50°C (32 to 122°F)
Ambient humidity	35 to 85% RH (no condensation)
Storage temperature	-10 to 60°C (14 to 140°F)
Dimensions	H × W × D = 140 mm × 56 mm × 37 mm
Weight	Approx. 180 g (including batteries)
Standard included accessories	AA alkaline batteries ×2, Strap

*Note that specifications are subject to change without prior notice for product improvement purposes.

Names of components

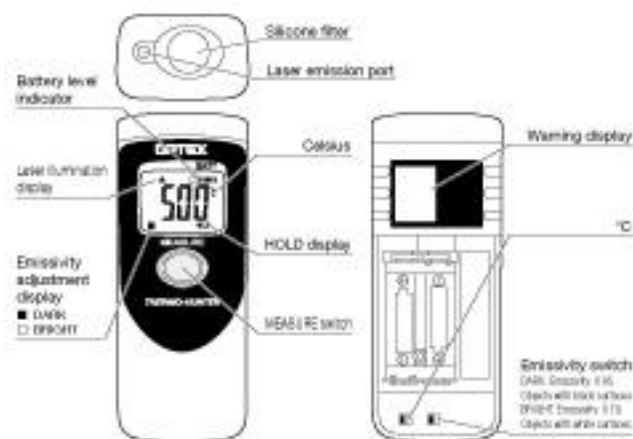

Field of view

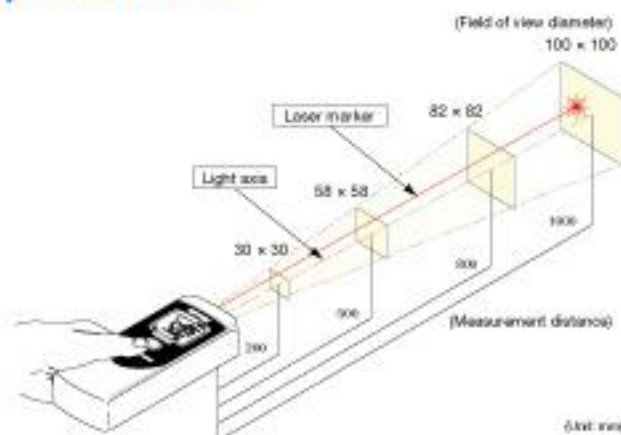

How to read the diagram

At 200 mm from a measurement target, the product measures the average temperature of the square surface area (30 mm × 30 mm).

*The laser marker is located 20 mm to the left of the light axis.

*The measurement fields of view stated above are measurement diameters with an optical response of 90%. The size of the measurement target must be sufficiently larger than the figures shown in the above diagram.

Options/Accessories

Black tape for glossy objects

HB-250



When attached to the surface of an object with unknown emissivity or a glossy object, this tape provides an emissivity of 0.95, enabling accurate non-contact temperature measurement. Emissivity on the PT-2LD can be switched between two levels. Set the emissivity to 0.95 (DARK) for use. The tape is built with material resistant to heat up to 250°C (482°F).
Tape size: 40 mm × 2000 mm

Correct use

Situations where measurement may be difficult

- When measuring a mirror-like surface such as shiny metal.
(*Measure after attaching optional accessory HB-250 or after creating a matte finish using sand or the like.)
- When measuring through glass.

Correct use

- Be sure to read the instruction manual thoroughly before using the product.
- This instrument is not a thermometer for taking body temperatures. It is not intended for use in medical practices.
- This product is not waterproof. Do not use this product in water or in a location where it may be exposed to water.
- Sudden changes in ambient temperature can cause measurement errors. Please ensure the product is not subject to sudden temperature changes during use.
- Avoid using the product near objects that generate strong electromagnetic waves.

Laser beam

- This product uses a Class 2 laser that conforms to JIS C 6802.
- Use the product according to the affixed warning labels.
- This product is a portable device that features a laser marker certified by JQA (Japan Quality Assurance Organization).

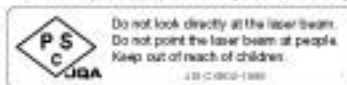

Exporting

- Laser warning labels.
Product specifications and warning labels may differ slightly depending on the laws and compliance standards of the export destination country. Contact us for details.

Selection guide

Stationary-type

CS

SA-80

BA

BA-TC

BS

BS-02

BF

Portable-type

PT-7LD

PT-5LD

PT-S90

PT-U80

PT-2LD

PT-3S

Q & A

Support